

DCS1600ART

ARTICULATION

User Manual



Content

1) Product Features -----	4
2) Getting Started-----	5
3) Manipulate -----	6
4) Specification -----	8
5) Trouble Shooting -----	9
6) Insert Tube Maintenance-----	9
7) Camera and Lens cleaning -----	9
8) Special Warning -----	11

1) Product Features

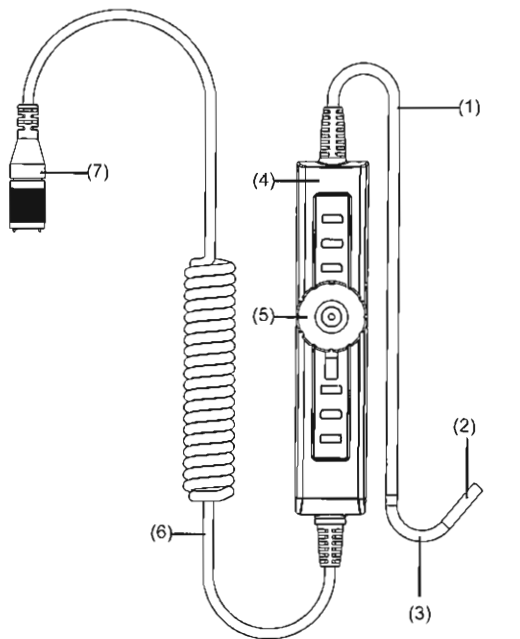



- | | |
|------------------|----------------------|
| (1) Insert Tube | (5) Control Wheel |
| (2) Camera Lens | (6) Connecting Cable |
| (3) Bending Neck | (7) Connector |
| (4) Console | |

2) Getting Started

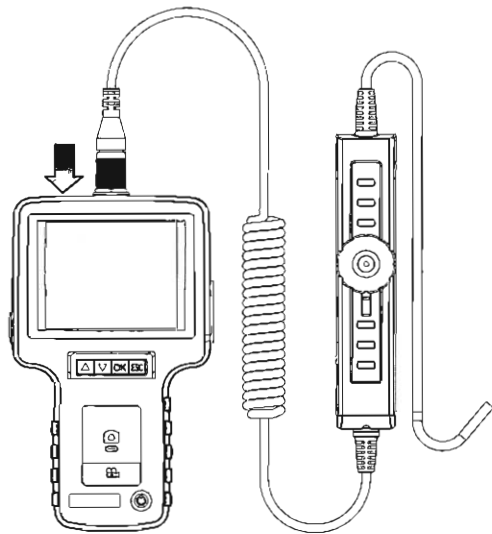
- Step 1 **Connect** handle with your console. And then tighten the screw nut.



- Step 2 Turn on your console until the image is displayed on the monitor.
- Step 3 Aim the camera lens at the selected object. Press  to capture a .JPG image, or  to begin recording a .ASF video.

3) Manipulate

Moving View

Want to bend the tip right side, just rotate the control wheel clockwise.
Want to bend to the left side, just rotate the wheel counter clockwise.

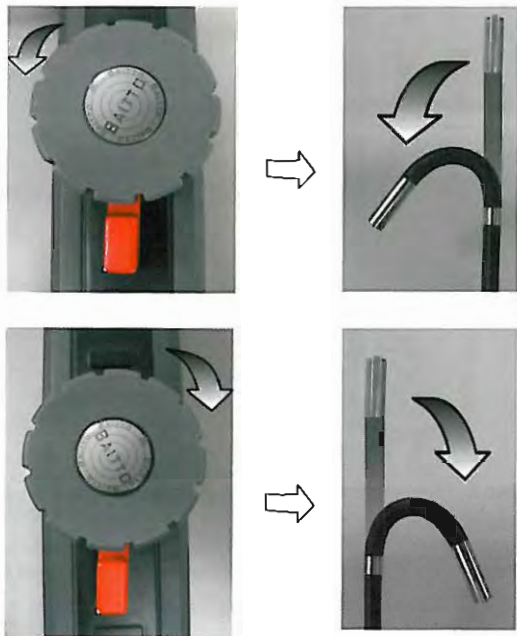

Lock

Twist the knob clockwise to lock bending neck in place. When you want to fix the bending neck angle, just twist the lock shaft clockwise to the lock position.

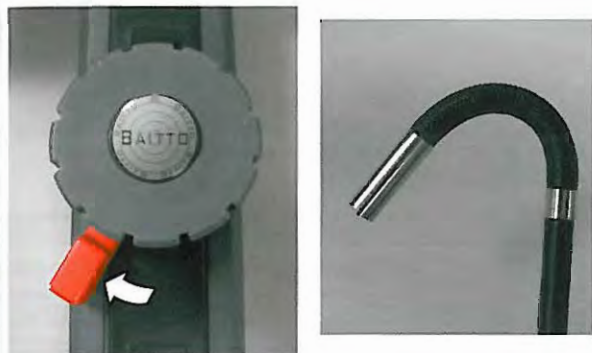

Light Adjustment

Twisting light adjusting wheel on your console to adjust the brightness of the light source.



4) Specification

Camera system & Insert tube		
Insert tubes diameter	6.0 mm	
Resolution	325(H)*250(V)	
Housing	stainless Steel	
Light Source	White LED	
Length	1M (Option: 2M, 3M)	
Field of View	Horizontal field angle	46°
	Vertical field angle	34°
	Diagonal field angle	56°
Depth of Field (DOF)	1cm~6cm	
Working Temperature	0°C~55°C	
Articulation Angle	2 Way	
Articulation Radius	48 +/-1mm	
Handle		
Dimension	139.3 * 34.9 * 31.8mm	
Weight	0.220kg	

5) Trouble Shooting

1.Unable to turn on the console

Users will not be able to turn on the console when the battery is very low or empty. Please re-charge before use.

2.Can turn on the unit but the image does not appear on the monitor

Please check the insertion tube connector or simply re-connect the insertion tube to correct the problem.

3.Unable to capture photos/videos

Please check the status of the SD card. Users will not be able to capture photos or videos if the SD card is not installed properly or if it is full, write protected or damaged.

6) Insert Tube Maintenance

- To avoid danger, please do not put the insert tube into any flammable liquid or gas.

- The insert tube contains a series of small wires that control the optics and electronics of the camera tip. To ensure long-term reliability, do not bend the insert tube more than 180 degrees, and always bend the insert tube in an arc as large as possible during usage and storage.

7) Camera and Lens cleaning

- User may clean the camera lens with a cotton swab and small amount of cleaning naphtha.

- The articulation handle is designed for industrial use only. Do not use the system for human or any other biological inspection.
- Do not insert the insert tube into any flammable gas or liquid (such as a fuel tank) to avoid dangers.
- Do not use the articulation handle in a fuel tank or other dangerous environments such as a gasoline or alcohol storage tank.
- Do not use any corrosive liquid for cleaning, such as alcohol.
- Do not try to disassemble the product. This presents a shock hazard and could damage the unit.
- Do not bend the insert tube over 180 degrees during usage or storage.
- Please use only recommended components or accessories. Unapproved accessories and components may cause damage.
- Please do not use the articulation handle in a medical facility or on an airplane, as the wireless signal may interfere with other critical equipment nearby.
- Avoid direct exposure to sunlight for long periods of time.
- Store the system in a cool, dry and well-ventilated place.

8) Special Warning

Bending neck is precise component, DO NOT load heavy load on this.

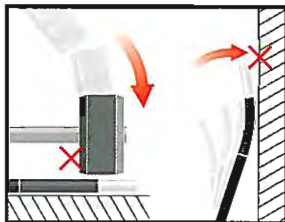

Never use the camera lip as a HOOK.

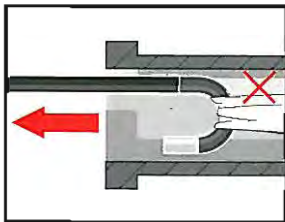

NEVER bend the bending neck directly, only bend by control wheel.

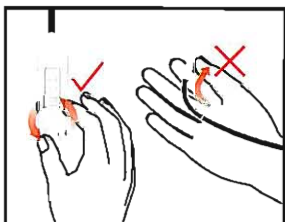

DO NOT rotate the controlling wheel when it is at the maximum angle.

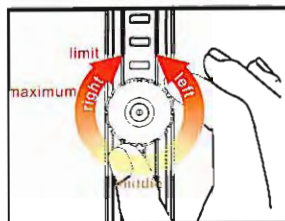

Insert tube is water-repellent. Please DO NOT immerse into any liquid.

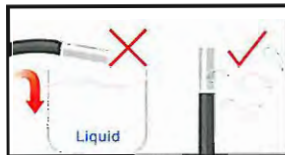

Working temperature is 0-55°C



Please straighten the bending neck before storage.

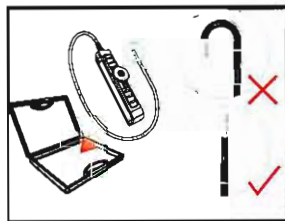

DO NOT bundle the insert tube less than a 15CM circle in storage.

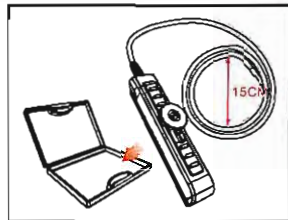

Please keep the insert tube straight in use.

